

PROLISTEL P ALL

ANODISED, POLISHED,
BRUSHED ALUMINIUM and TILTEX

PROLISTEL P ALL is a decorative strip that adds colour effects to ceramic-tiled walls. Its angular design makes it suitable for walls tiled with rectified porcelain stoneware. It can also be used to separate two floors made of the same and/or different materials. The strip is applied with the same adhesive used for ceramic or wood. Available in various finishes: glossy (Polished), brushed (Polished Brushed), Anodised and new TILTEX brushed finish. Best results when matched with the same colour schemes of **PROJOLLY**, **PROTERMINAL**, **PROBORD** and **PROJOLLYSQUARE**.

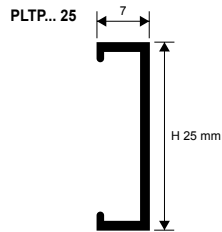
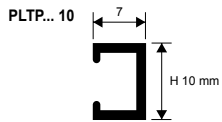

EXAMPLES AND INSTRUCTIONS FOR LAYING METHODS

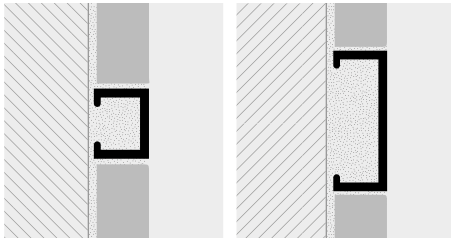

1: Choose the preferred finish. 2: Spread the adhesive on the place of application. 3: Apply and align the profile, after cutting to length. 4: Lay the tiles/ceramic or spread the resin, aligning the profile so that the top is flush.



ANODISED ALUMINIUM (silver-copper-titanium) thermo packed
bar length 2,7 LM - packaging 10 Pcs - 108 LM

Article	H mm		
PLTPAA 10 (anod. silver)	10		
PLTPAR 10 (anod. copper)	10		
PLTPAT 10 (anod. titanium)	10		
PLTPAA 25 (anod. silver)	25		
PLTPAR 25 (anod. copper)	25		
PLTPAT 25 (anod. titanium)	25		

POLISHED ALUMINIUM (chrome-titanium-copper) thermo packed
bar length 2,7 LM - packaging 40 Pcs - 108 LM

Article	H mm		
PLTPBC 10 (polished chrome)	10		
PLTPBR 10 (polished copper)	10		
PLTPBT 10 (polished titanium)	10		
PLTPBC 25 (polished chrome)	25		
PLTPBR 25 (polished copper)	25		
PLTPBT 25 (polished titanium)	25		

BRUSHED ALUMINIUM (silver-copper-titanium) thermo packed
bar length 2,7 LM - packaging 40 Pcs - 108 LM

Article	H mm		
PLTPBS 10 (brush. silver)	10		
PLTPRS 10 (brush. copper)	10		
PLTPTS 10 (brush. titanium)	10		
PLTPBS 25 (brush. silver)	25		
PLTPRS 25 (brush. copper)	25		
PLTPTS 25 (brush. titanium)	25		

BRUSHED ALU. TILTEX (silver, copper and titanium) thermo packed
bar length 2,7 LM - packaging 40 Pcs - 108 LM

Article	H mm		
PLTPBX 10 (silver) TILTEX	10		
PLTPRX 10 (copper) TILTEX	10		
PLTPTX 10 (titanium) TILTEX	10		
PLTPBX 25 (silver) TILTEX	25		
PLTPRX 25 (copper) TILTEX	25		
PLTPTX 25 (titanium) TILTEX	25		

COLOURS

(for a precise assessment of colours and finishes, see the relative enclosed sheet)

ANODIZED			POLISHED		
AA - Anod. silver aluminium	AR - Anod. copper aluminium	AT - Anod. titanium aluminium	BC - Polished chrome alu.	BR - Polished copper alu.	BT - Polished titanium alu.
BRUSHED			BRUSHED TILTEX		
BS - Brushed silver alu.	RS - Brushed copper alu.	TS - Brushed titanium alu.	BX - silver TILTEX	RX - copper TILTEX	TX - titanium TILTEX

